



DARWIN COURT, E13

£1,500 PER MONTH

- First Come First Serve Parking
- Separate Reception Room
- Fitted Wardrobes
- Ground Floor Flat
- Double Bedroom
- Close to Plaistow Station

WJ
meade



est. 1953

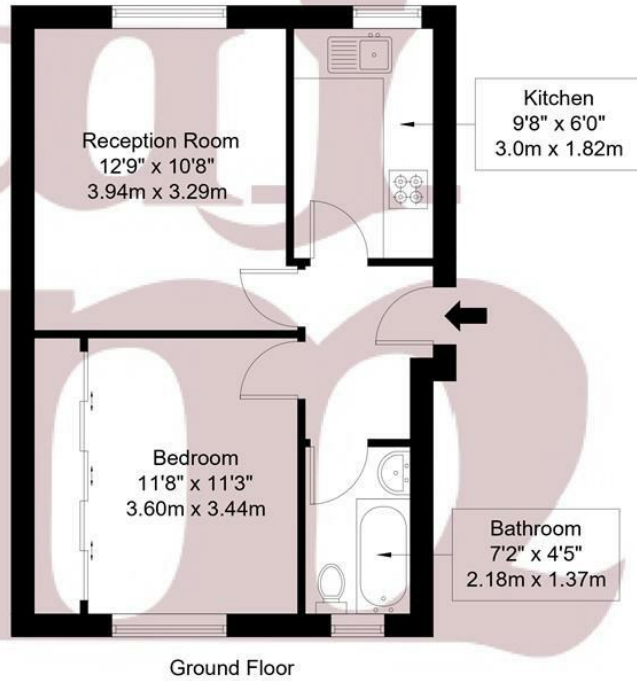

Approx Gross Internal Area = 39 sq m / 420 sq ft

The Floor plan is not to scale and measurements and areas shown are approximate and therefore should be used for illustrative purposes only. The plan has been prepared in accordance with the RICS code of Measuring Practice and whilst we have confidence in the information produced it must not be relied on. Maximum lengths and widths are represented on the floor plan. If there is any aspect of particular importance, you should carry out or commission your own inspection of the property.
Copyright @ BleuPlan



W J Meade are delighted to offer to the market this one bedroom ground floor flat to rent in Darwin Court, Plaistow. Comprising a spacious lounge, separate kitchen, double bedroom (with fitted wardrobes) and family bathroom. The property comes unfurnished and also benefits from 'first come, first serve parking'. Situated with close proximity to Plaistow Overground Station, local shops and amenities, the property is based in a great location.

Deposit is 5 week's rent.

Service charge £n/a

Ground rent £n/a

Reserve fund £n/a

n/a years lease

Council tax band B

Current EPC Rating 69

Tenure:



All sizes are approximate. The Agent has not tested any apparatus, equipment, fixtures and fittings, or services and so cannot verify that they are in working order or fit for the purpose. A buyer is advised to obtain verification from their Solicitors or Surveyor. Photographs are for illustration purposes only and may depict items, which are not for sale or included in the sale price. References to tenure of a property are based upon information supplied by the vendor. The agent has not had sight of the title documents, a buyer is advised to obtain verification from their solicitor. Money Laundering Regulations 2003: Intending purchasers will be asked to produce identification, documentation at a later stage and we would ask for your co-operation in order that there will be no delay in agreeing the sale.

These particulars are intended to give a fair description of the property only and are in no way guaranteed, nor do of any contract. They are issued on the express condition that all negotiations are conducted through W.J. Meade Estate Agents. All subject to contract and to being unsold.